

Maat A

70,00mm

6,00mm

33,0mm

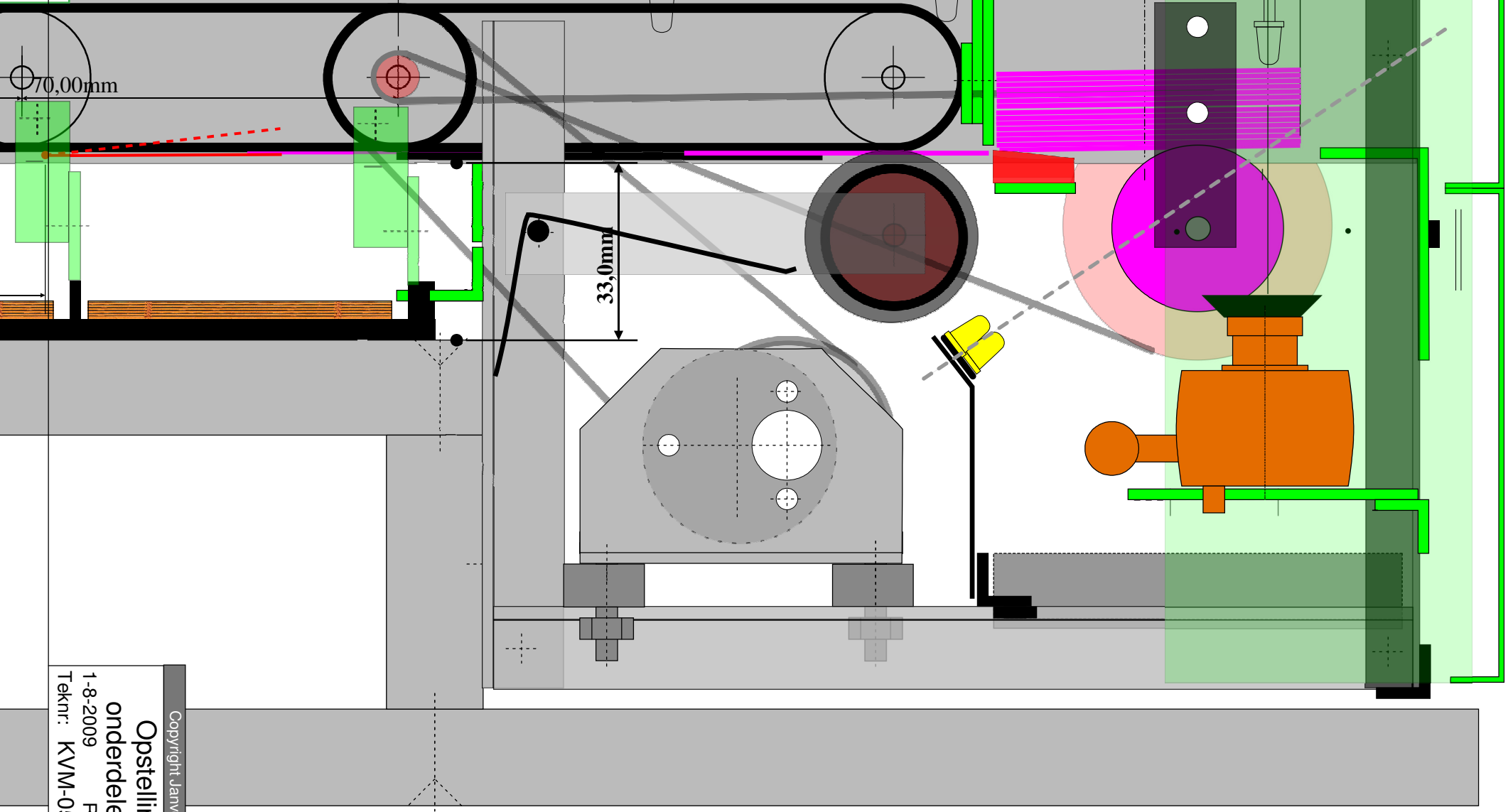

Copyright JanvdVen
Opstelling
onderdelen 1
1-8-2009 Rev:
Teknr: KVM-05

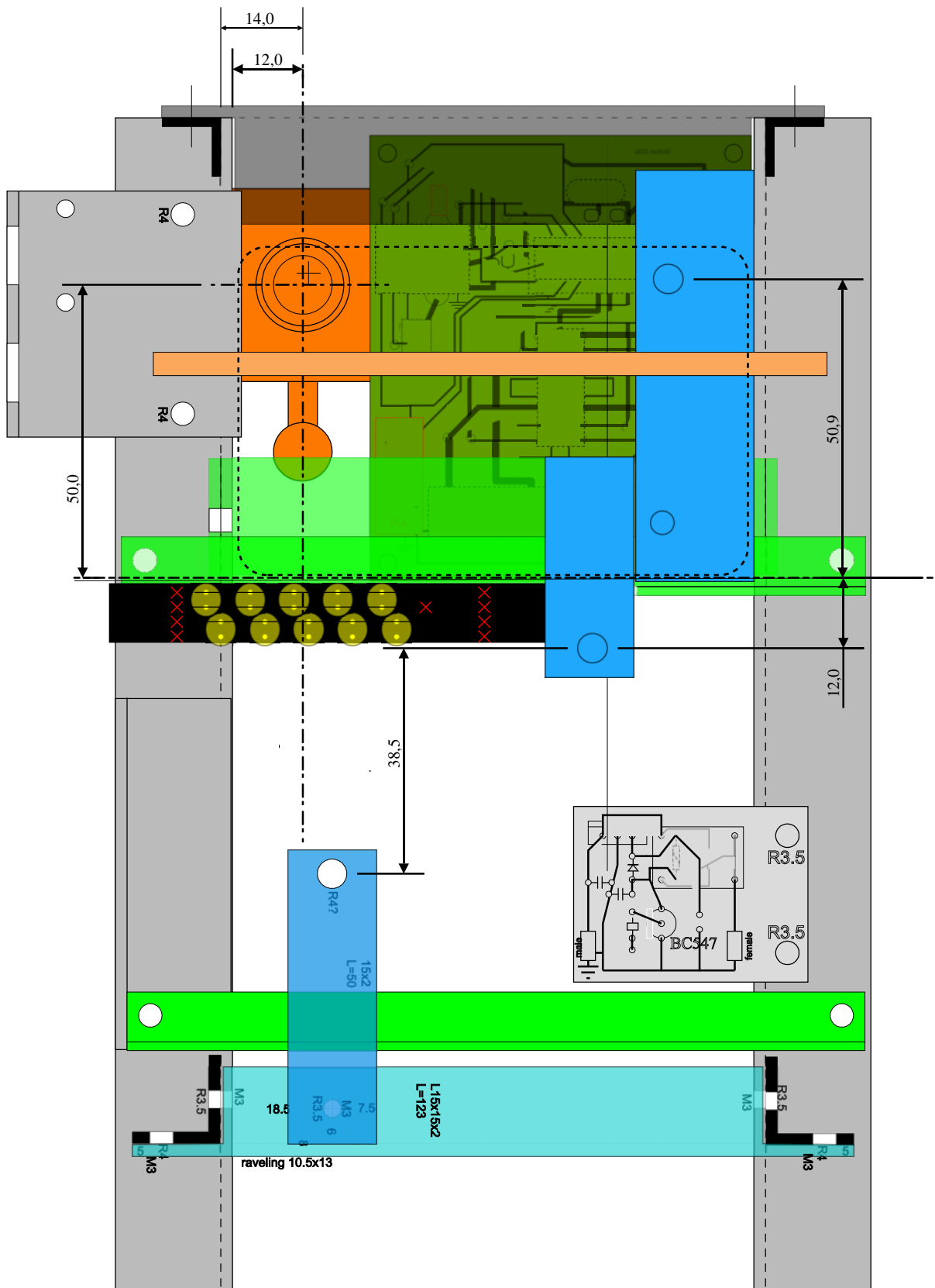

Copyright JanvdVen

Opstelling onderdelen 2

1-8-2009 Rev:
Teknr: KVM-06

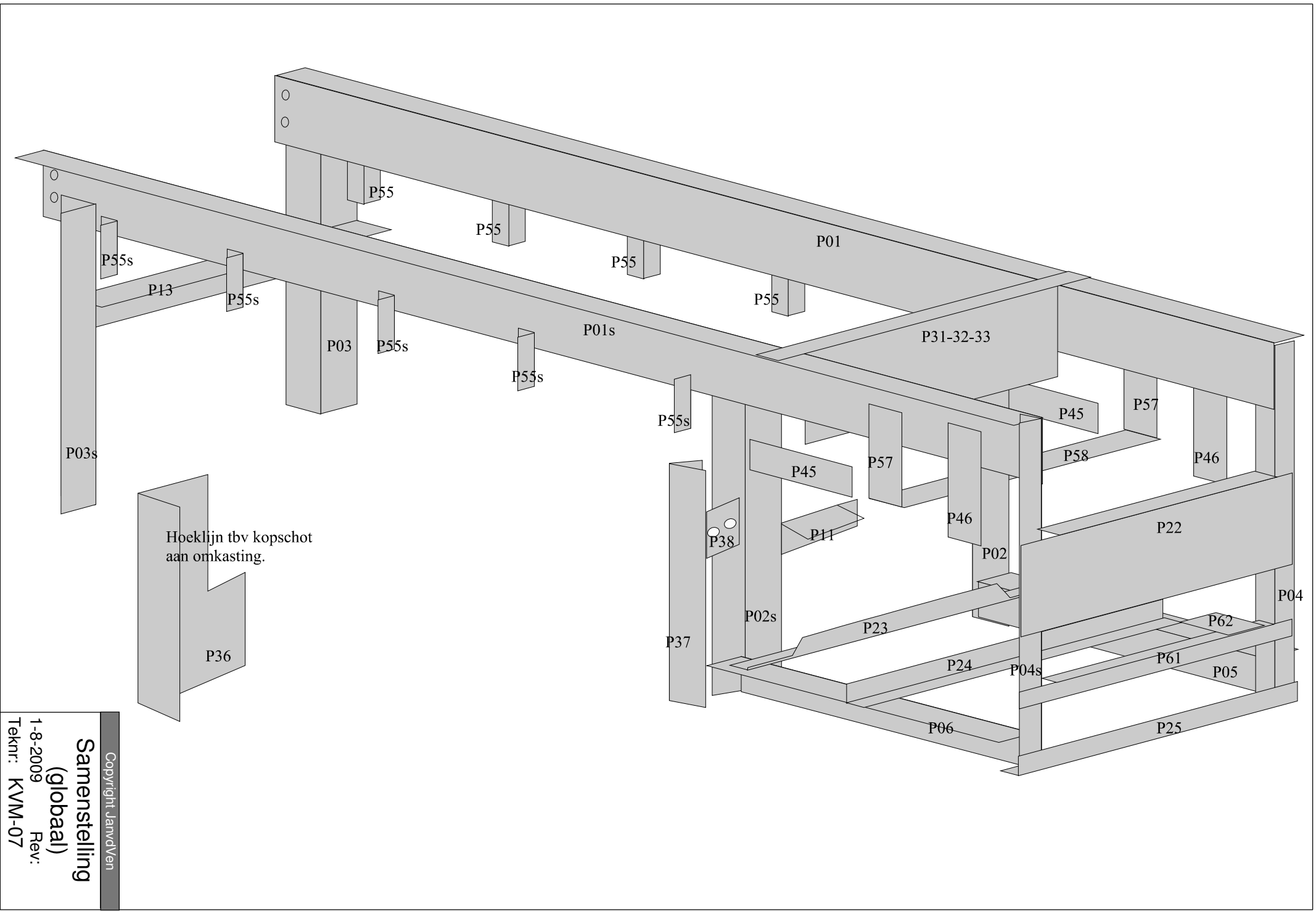

Copyright JanvdVen
Samenstelling
 (globaal)
 1-8-2009 Rev:
 Teknr: KVM-07

P01
Alu L40x20x2
1x L=487.5

P01s
Alu L40x20x2
1x L=487.5

P01s is het spiegelbeeld van P01

P01: alle WITTE en ZWARTE gaten boren.
P01s: alleen alle WITTE gaten (doorboren)

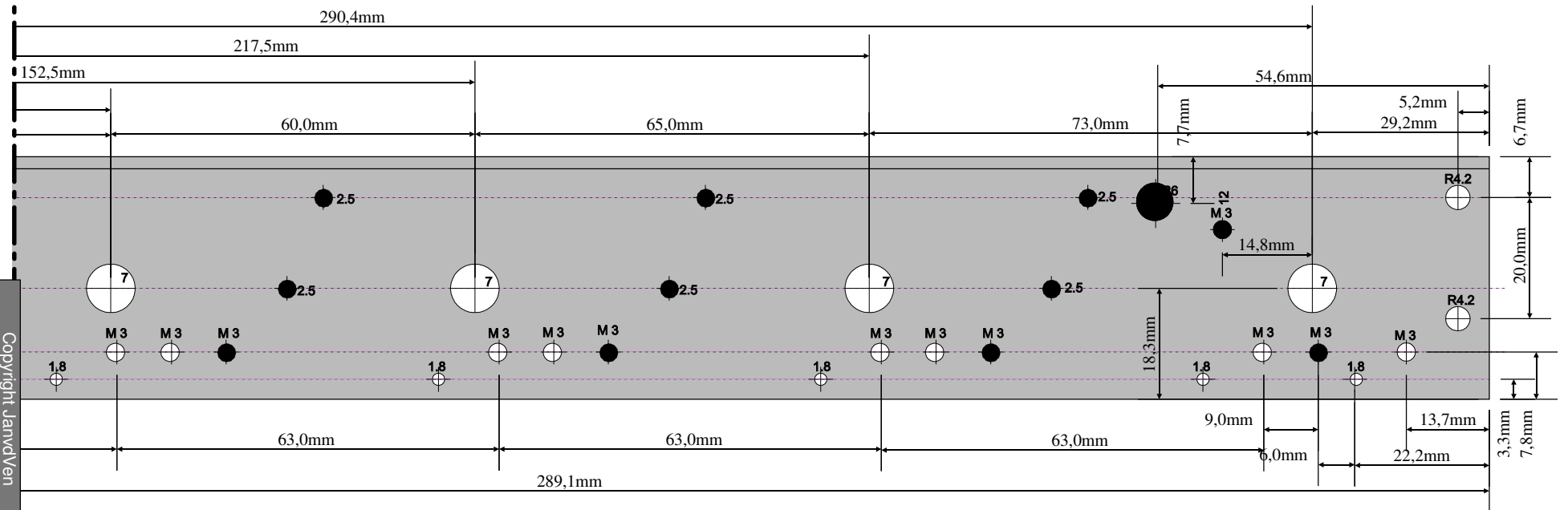
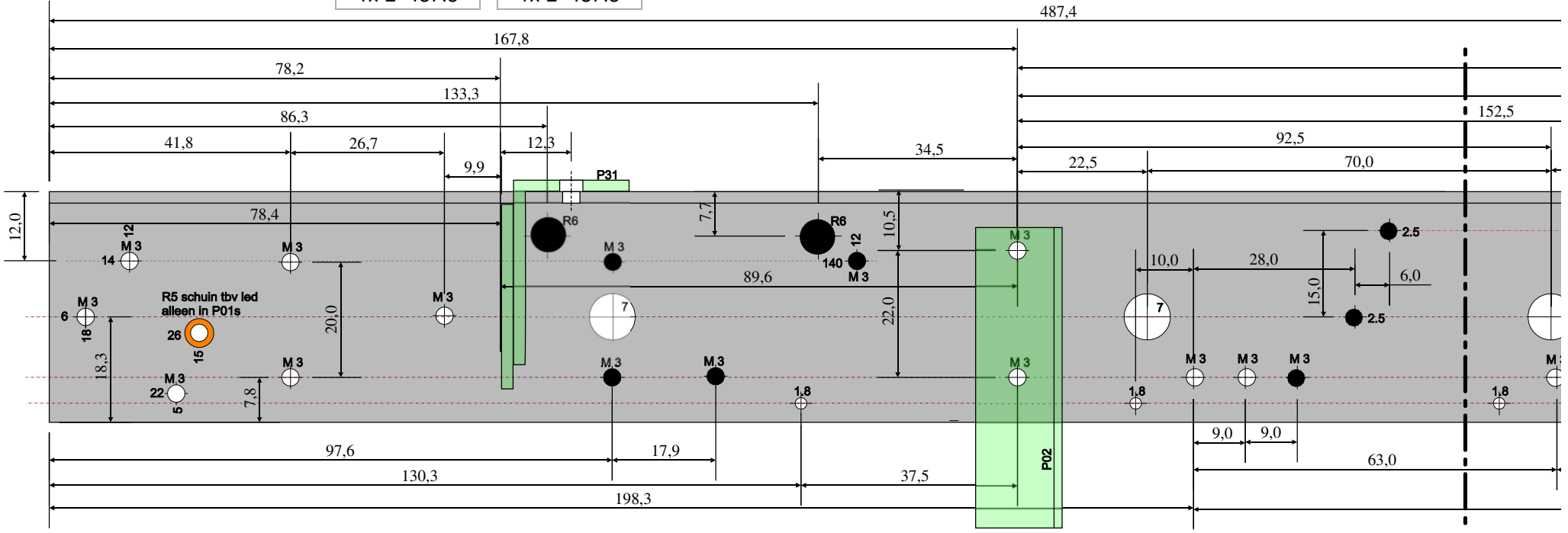

1-8-2009 Rev:
Teknr.: KVM-11

Copyright JanvdVen
Hoofdbeam

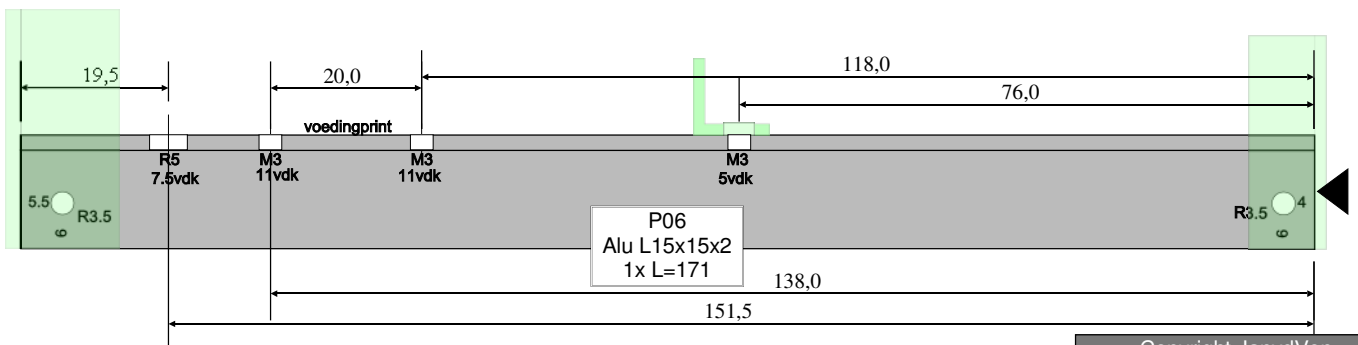
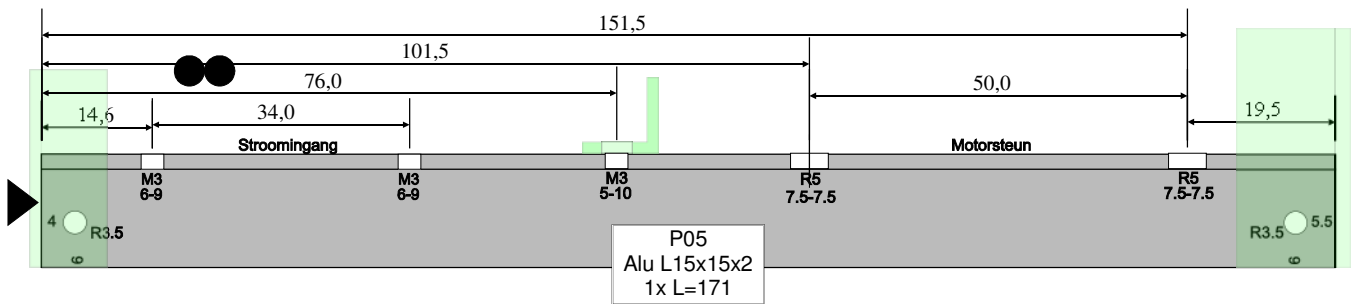
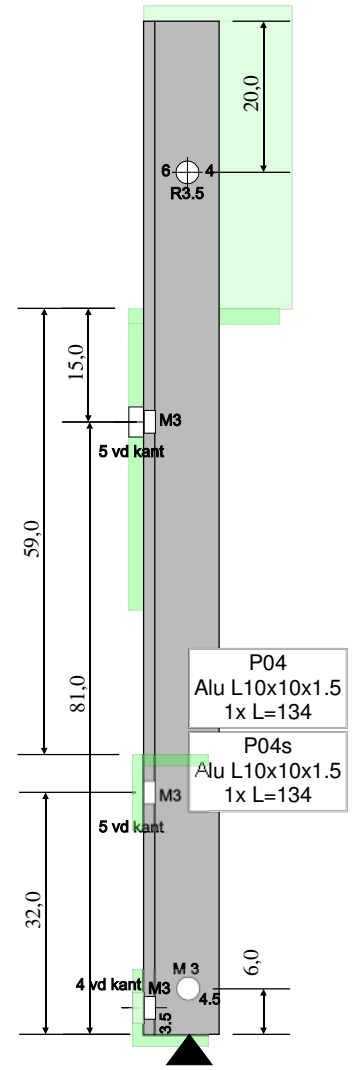
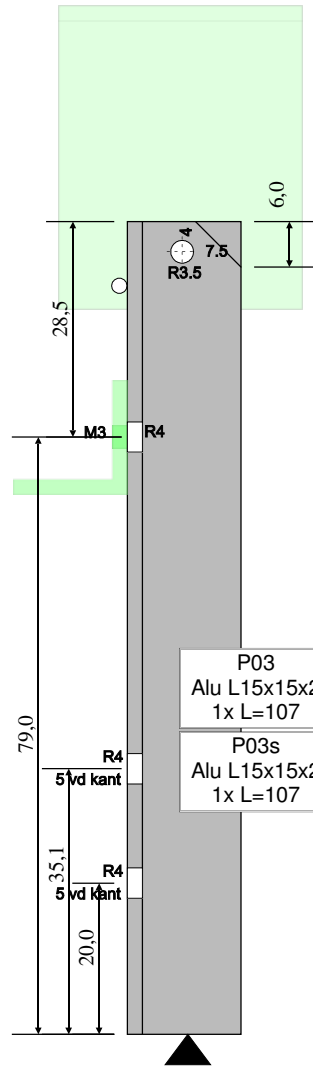
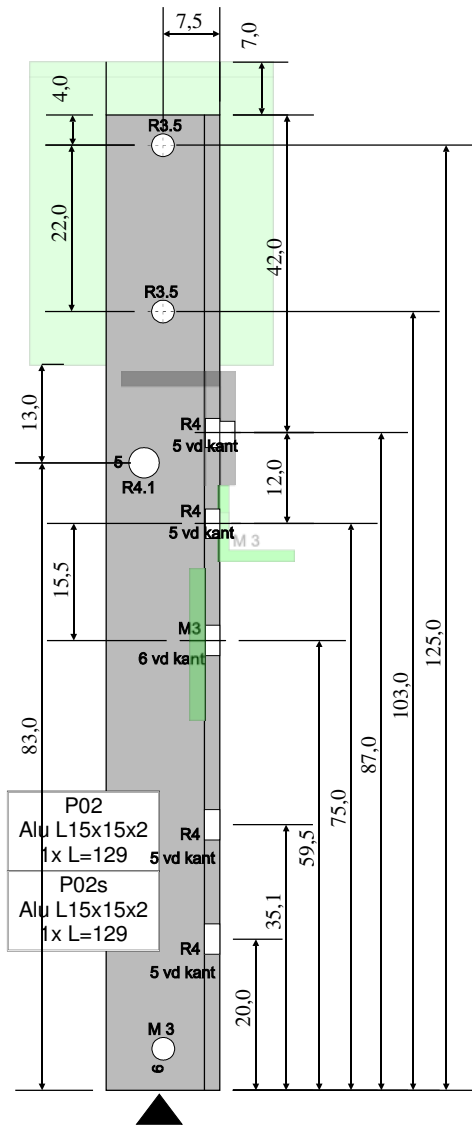

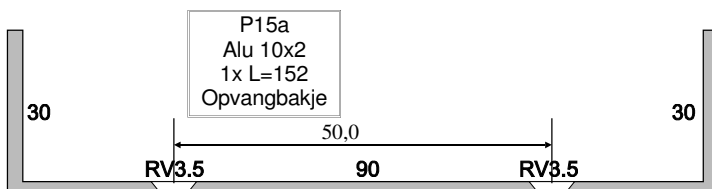
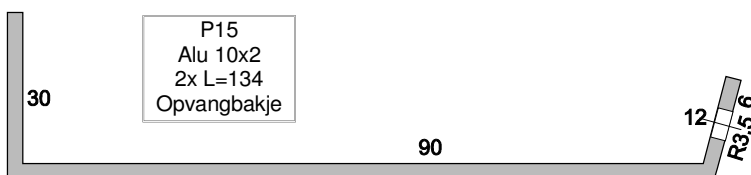
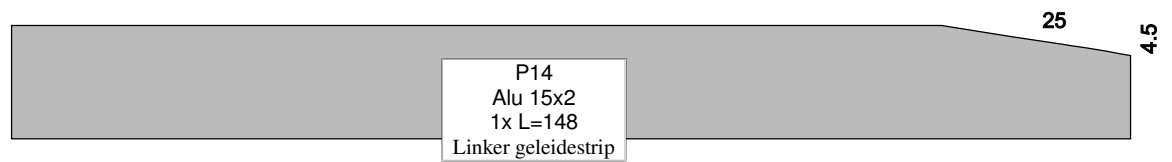
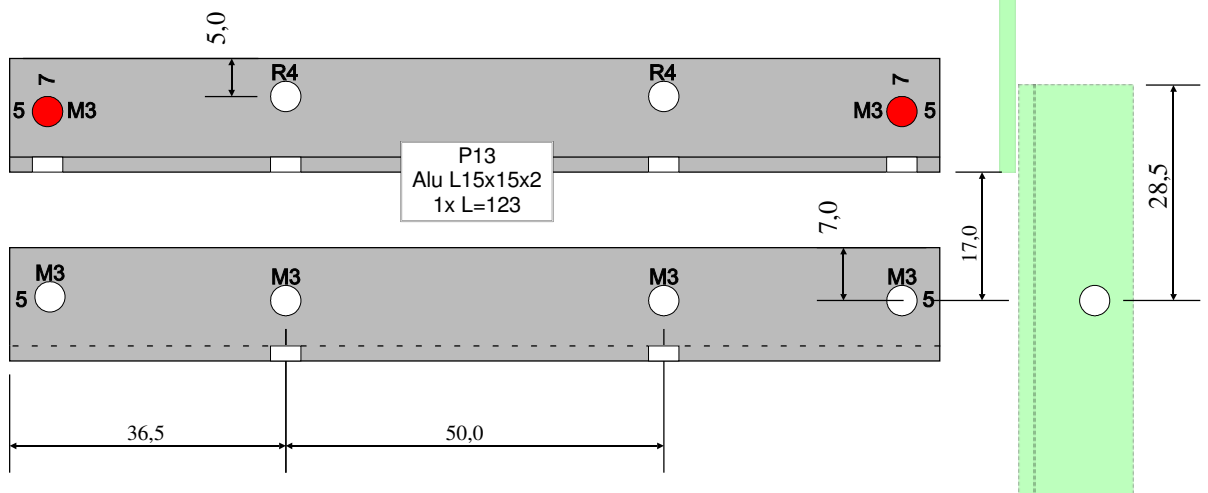
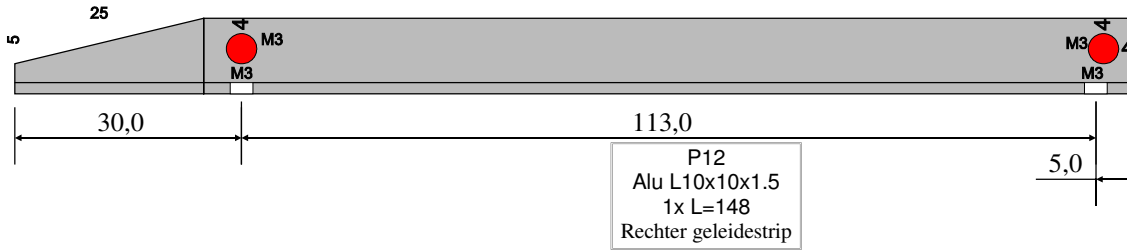
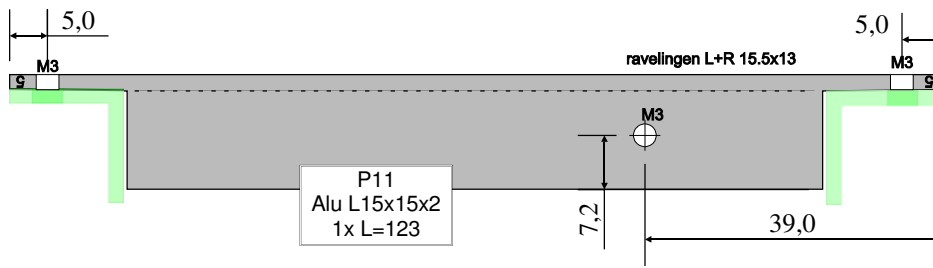

Copyright JanvdVen

Geleiders ed

1-8-2009 Rev:
Teknr: KVM-14

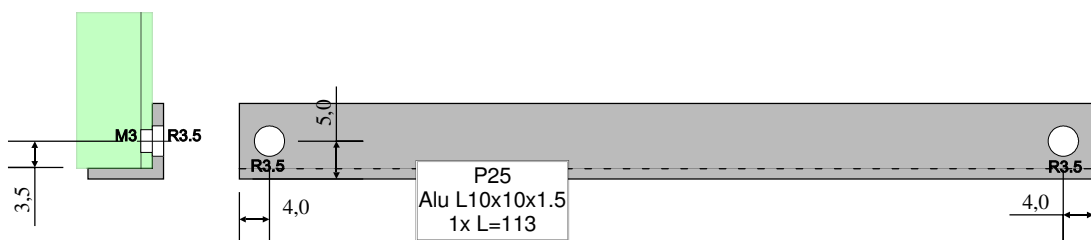
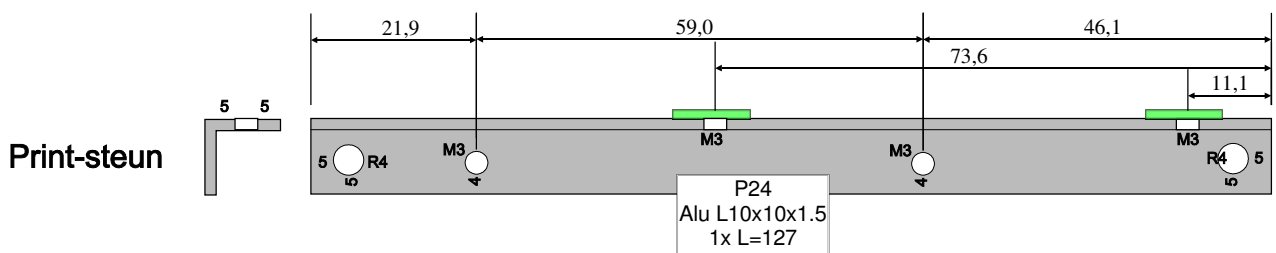
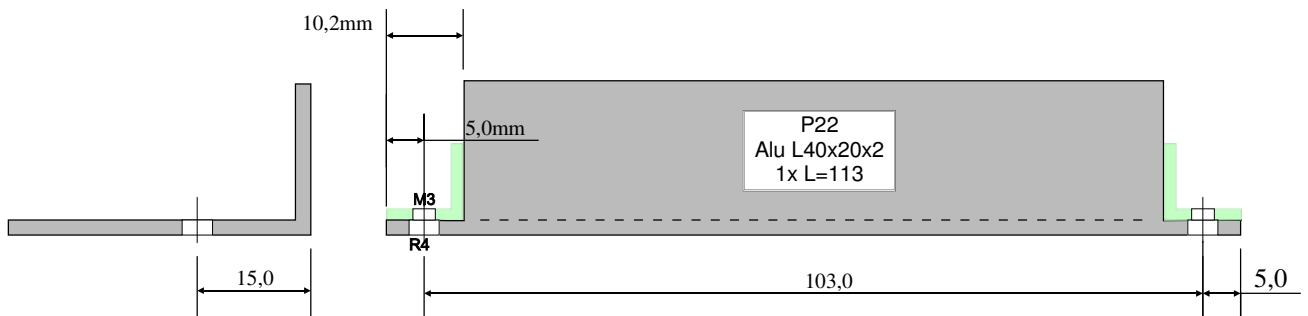
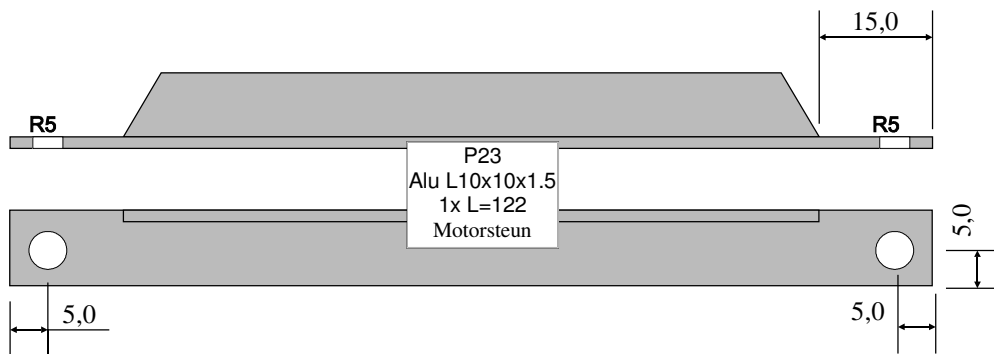
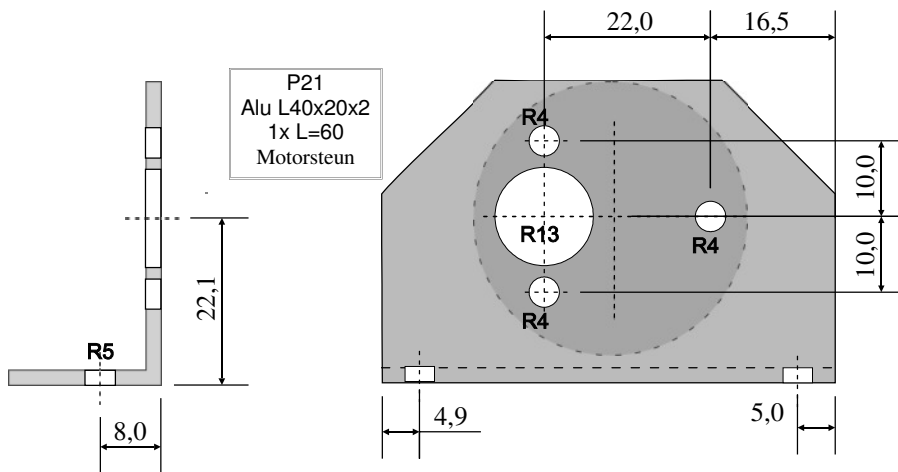

Copyright JanvdVen

Motor- printsteun
en einden

1-8-2009 Rev:

Teknr: KVM-15

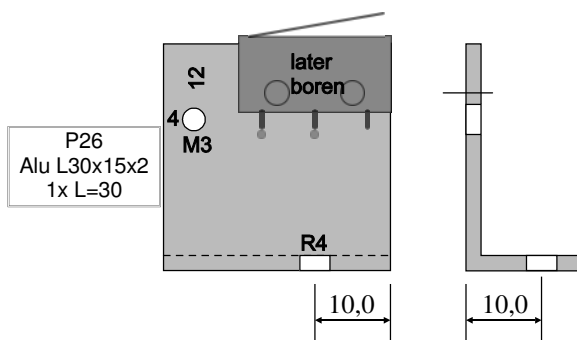
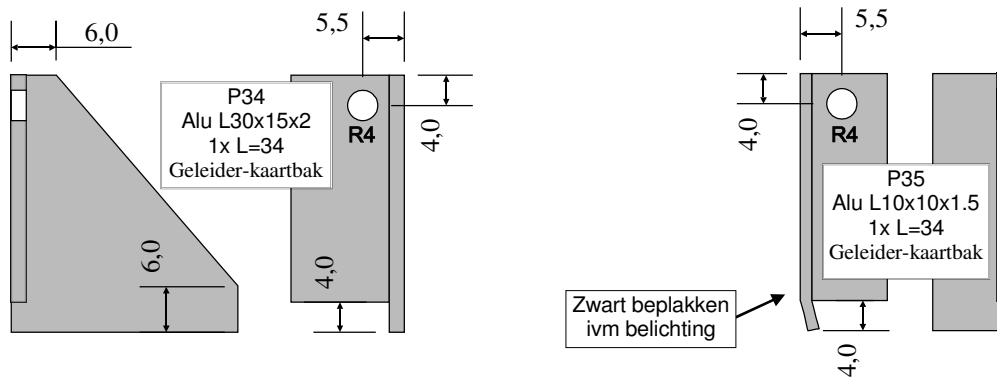
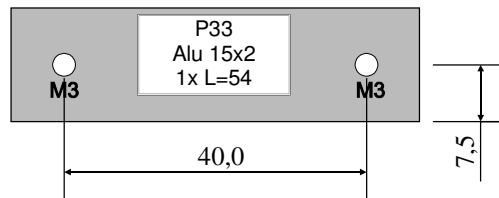
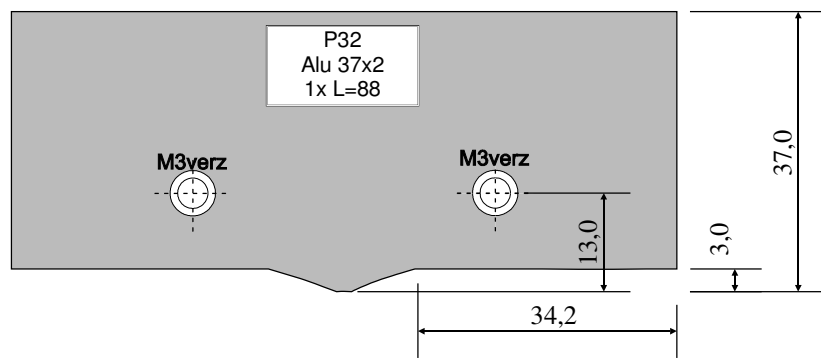
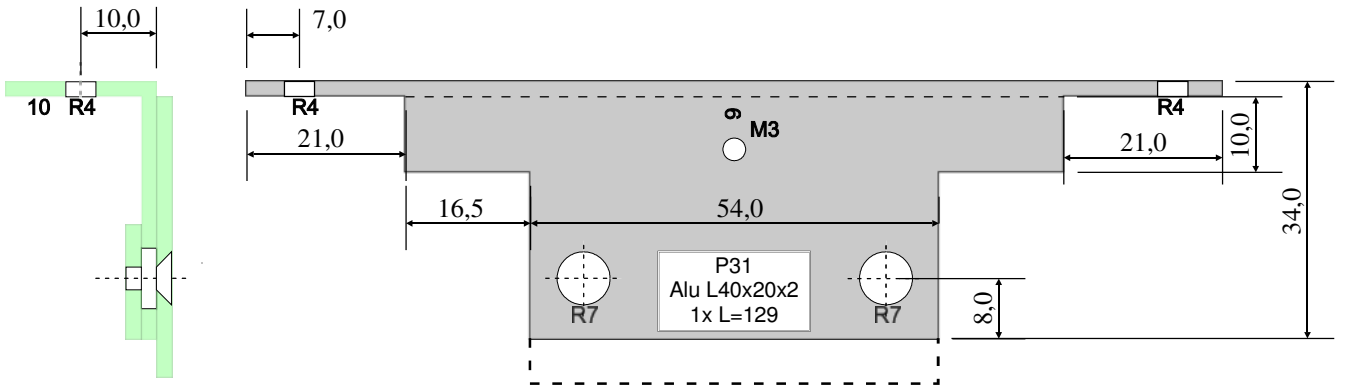

Copyright JanvdVen

Kaartbak

1-8-2009 Rev:
Teknr: KVM-16

Linker

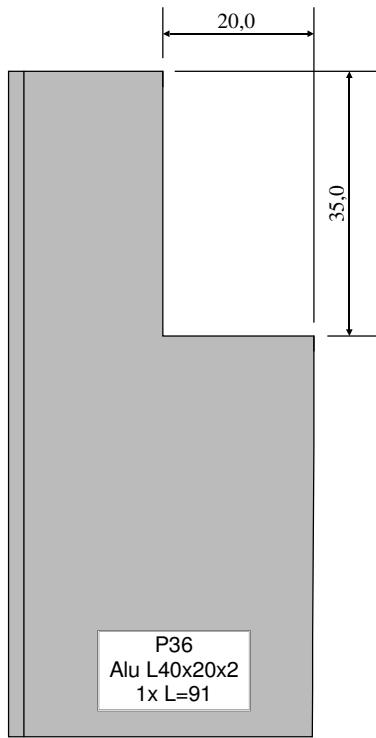

Rechter

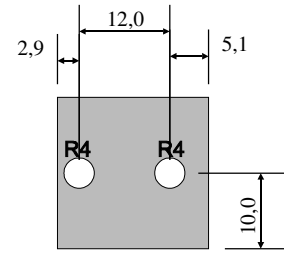
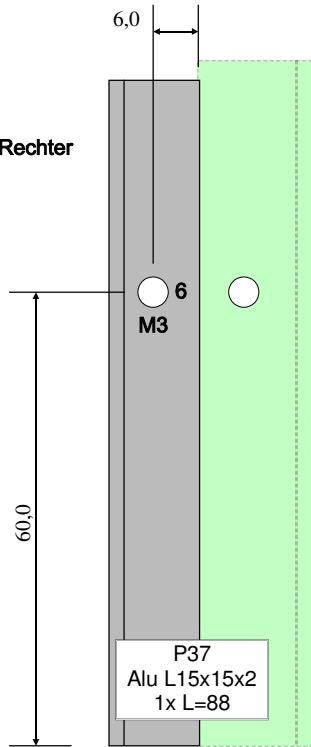

P38
Alu 20x2
1x L=20

12 Afzagen tot 12mm

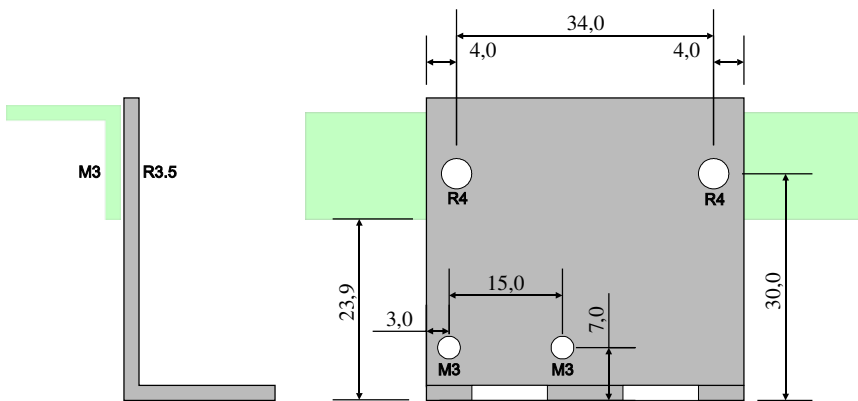

P39a
PVC 20x2
1x L=10

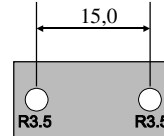

P39
Alu L40x20x2
1x L=42

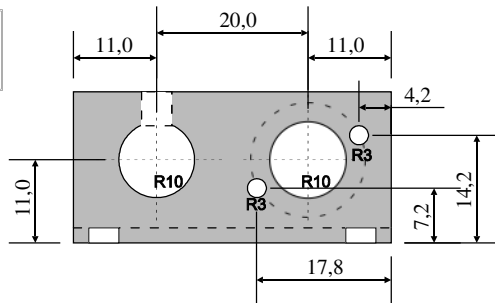

P39b
1x L=10

1x rubber dik 4
1x pvc dik 4



Copyright JanvdVen

**Kopschotjes
en stroomingang**

1-8-2009 Rev:

Teknr: KVM-17

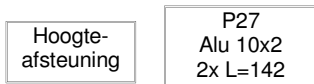
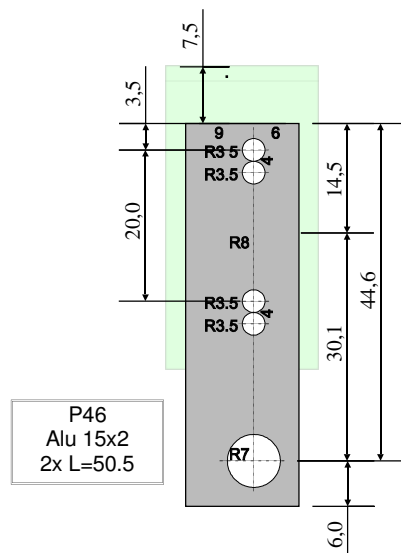
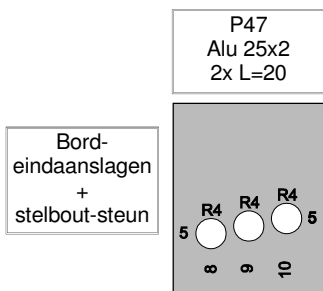
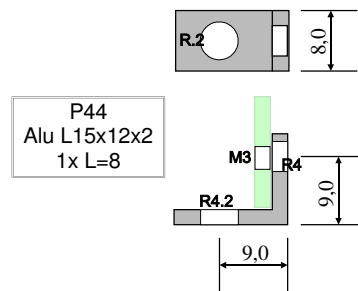
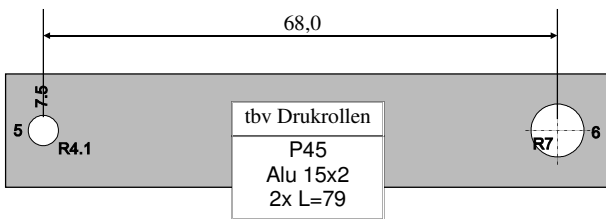
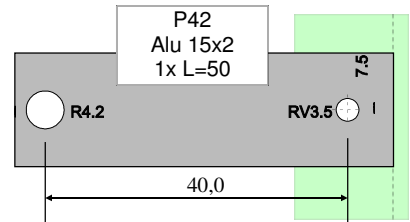
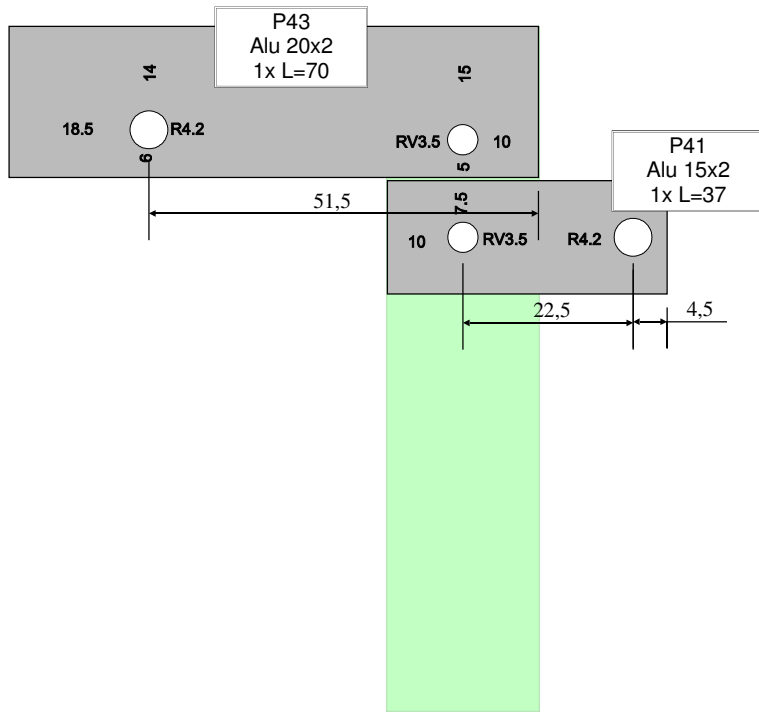

P51
Alu Buis R4-R6
2x L=89
Afstandhouders



P52
Alu Buis R4-R6
1x L=20
Kaartsluis

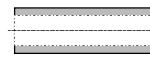

P53
Draadeind M4
2x L=101

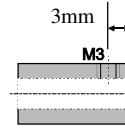

Kunststof
Buis R4-R8
1x L=15
Aandrijving

P54
Alu L10x10x1.5
4x L=22

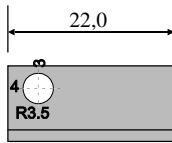

P55
Alu L10x10x1.5
5x L=26,5

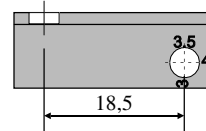

P55s
Alu L10x10x1.5
5x L=26,5

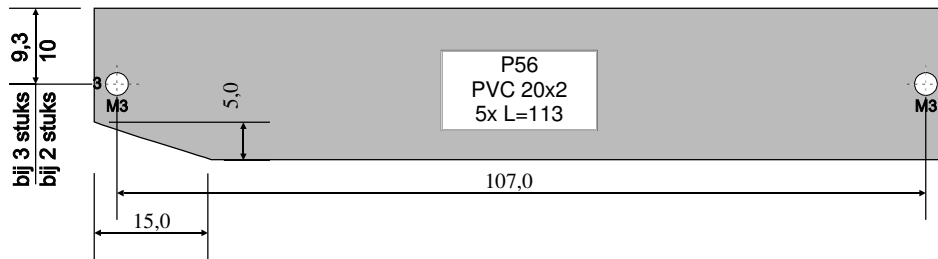
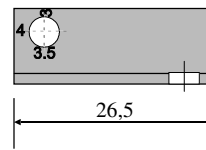

P57
Alu L30x15x2
2x L=20

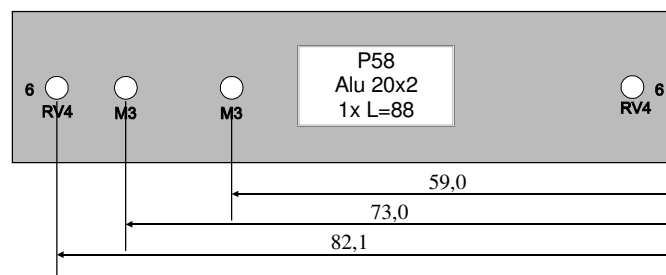
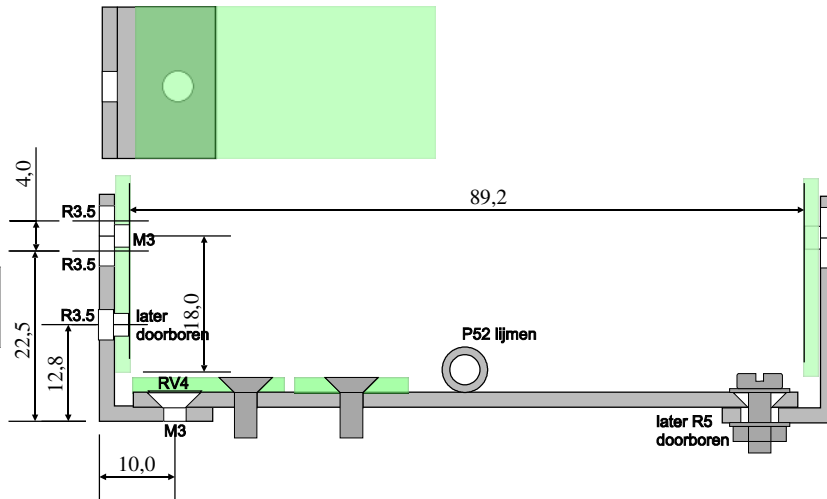

Copyright JanvdVen

Afstandhouders ed

1-8-2009 Rev:
Teknr: KVM-19

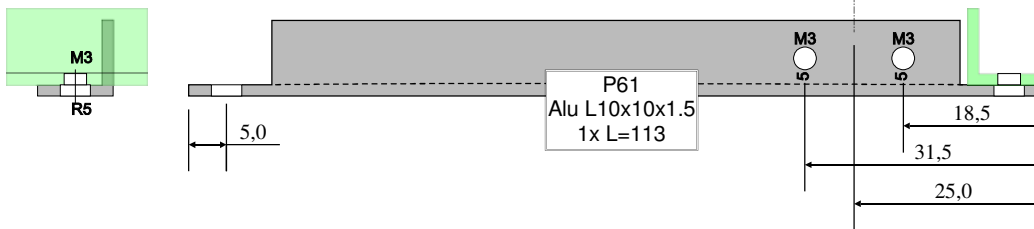

Geschikt voor camera's:
- pc camera 268

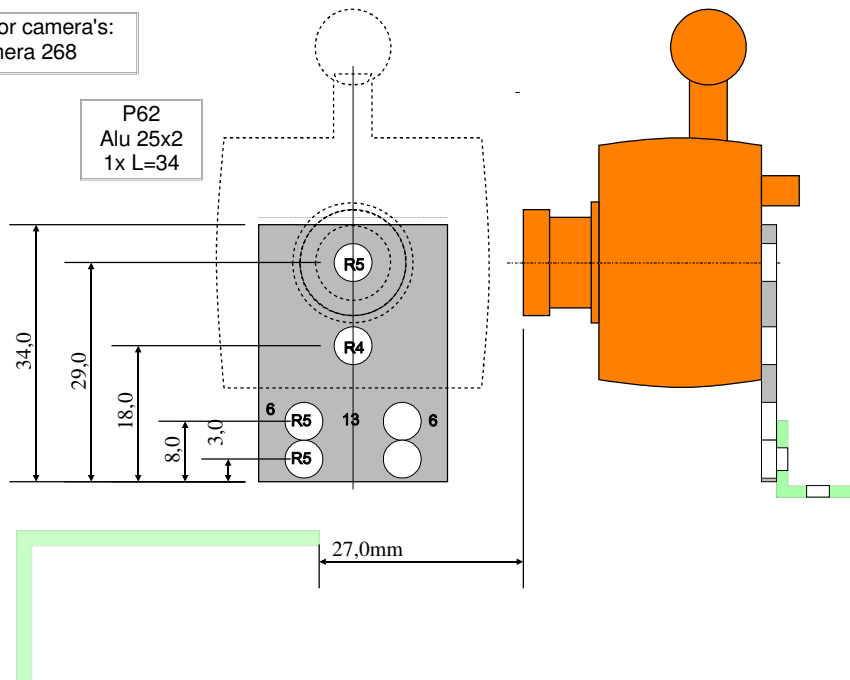

Materiaal: Aluminium plaat dik 1mm

Maten in mm (inwendig)

Oppervlaktebehandeling: onbewerkt

- - - - = zichtzijde

Strepen in de lengterichting

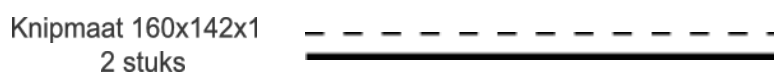
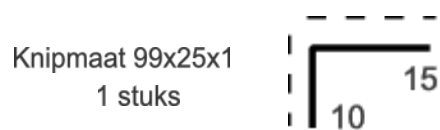
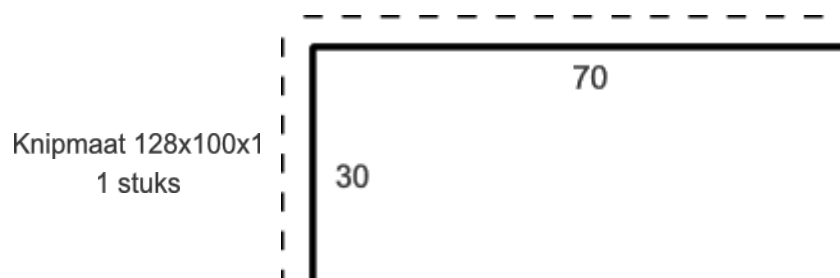
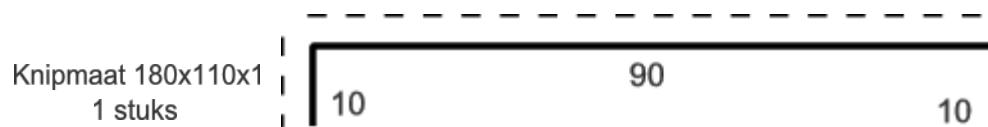
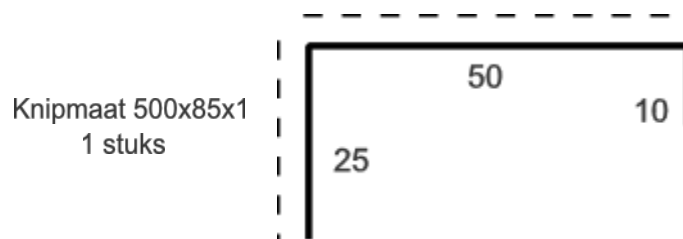
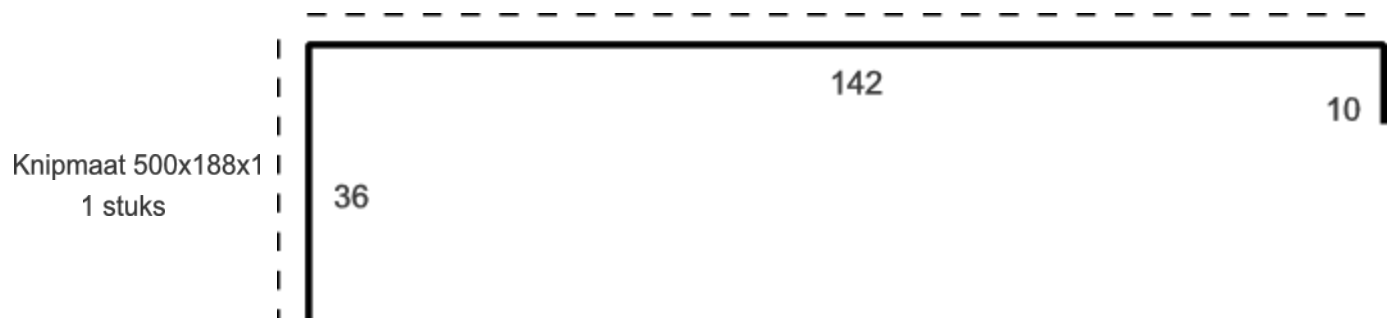

Copyright JanvdVen

Omkasting

1-8-2009 Rev:
Teknr: KVM-61

Materiaal: Aluminium plaat dik 1mm

Alle gaten rond 3.5 (tbv M3)

Alle zettingen naar achteren.

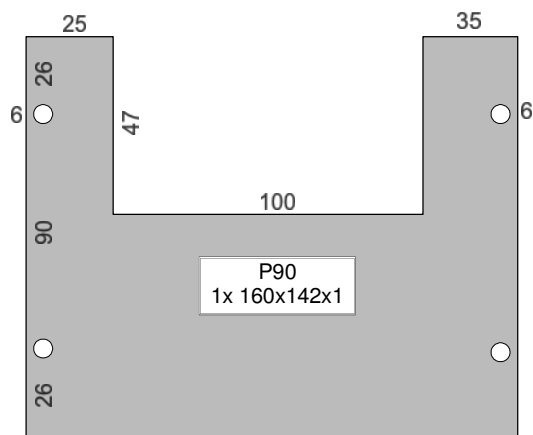
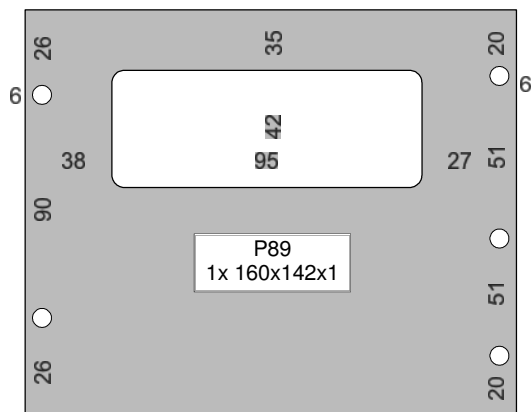
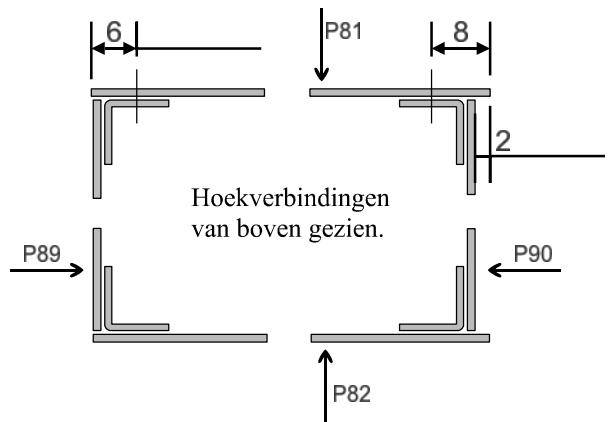
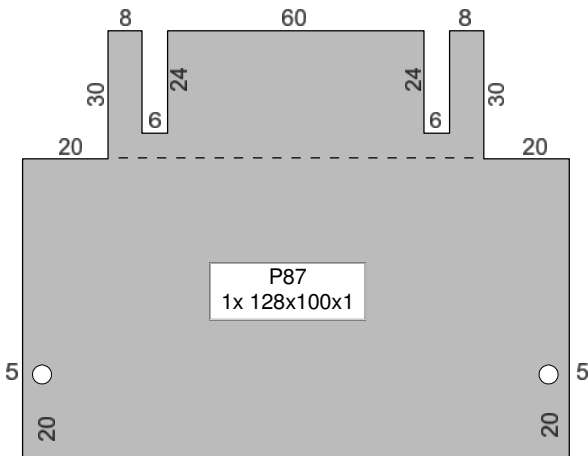
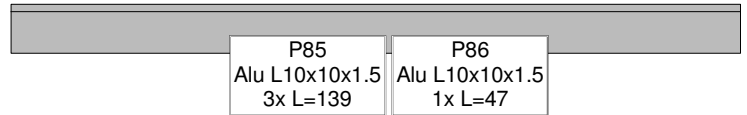
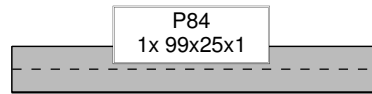
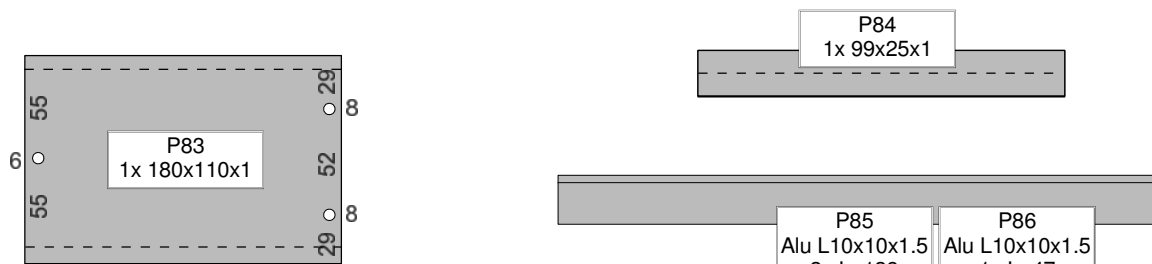
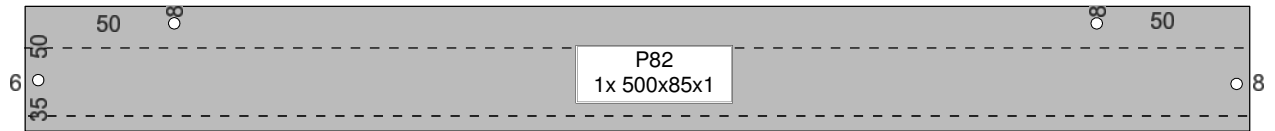
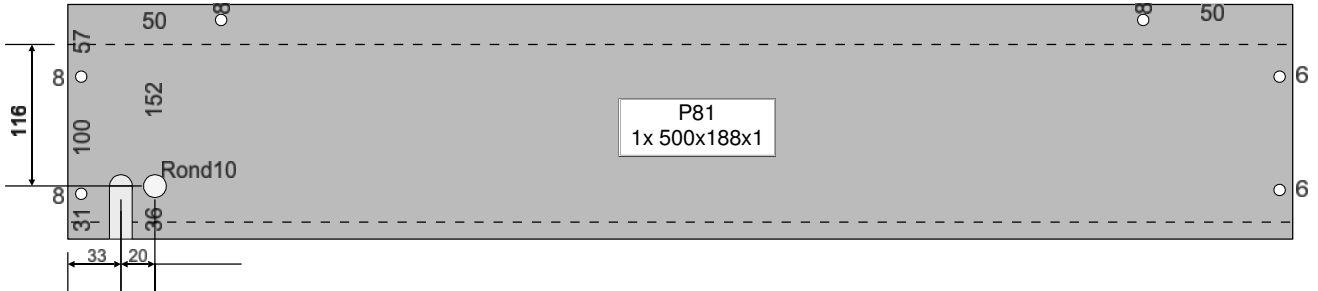

Copyright JanvdVen

Omkastings
uitslagen

1-8-2009 Rev:

Teknr: KVM-62

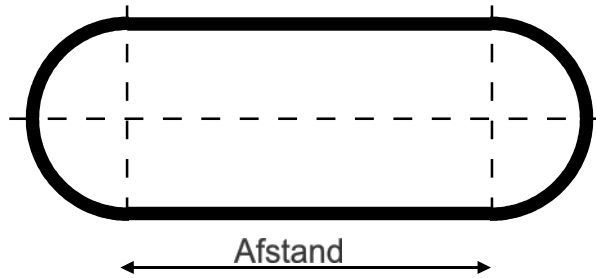

Materiaal: Rubber

Riembdikte 3mm			
Nr	Afstand	Lengte	Aantal
1	138	353	2x
2	130	337	2x
3	93	263	2x
4	0	72	4x
motorriem			
5	99	284	1x
Riembdikte 2mm			
6	151	381	1x

Asjes

Materiaal: staal of alum
Rond 4.0mm (passend in de lagers!!)

1 stuks L=130mm (sta)	Aandrijf
1 stuks L=130mm (sta of alu)	Kaartbak
1 stuks L=115mm (sta)	Lagering
6 stuks L=115mm (alu)	Rest

Copyright JanvdVen

Aandrijfriemen
Asjes

1-8-2009 Rev:
Teknr: KVM-71

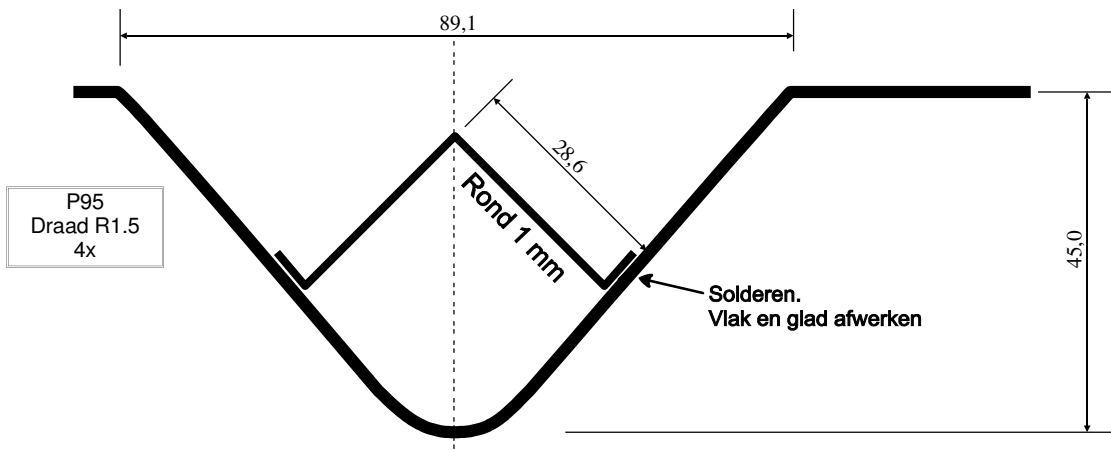

Neus
ca 1 mm
naar beneden

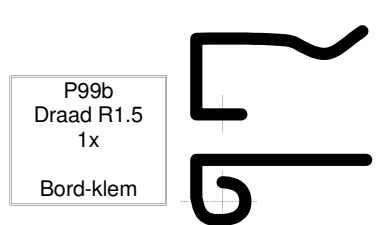
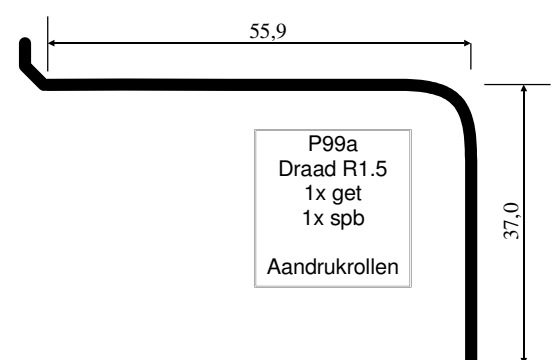
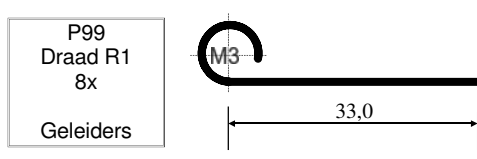
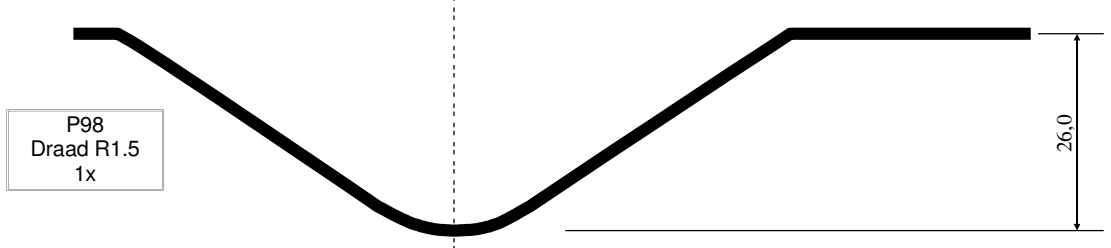
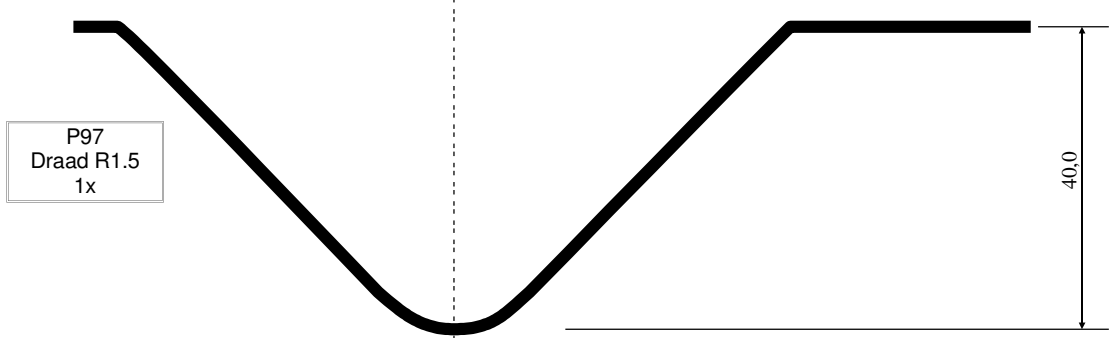
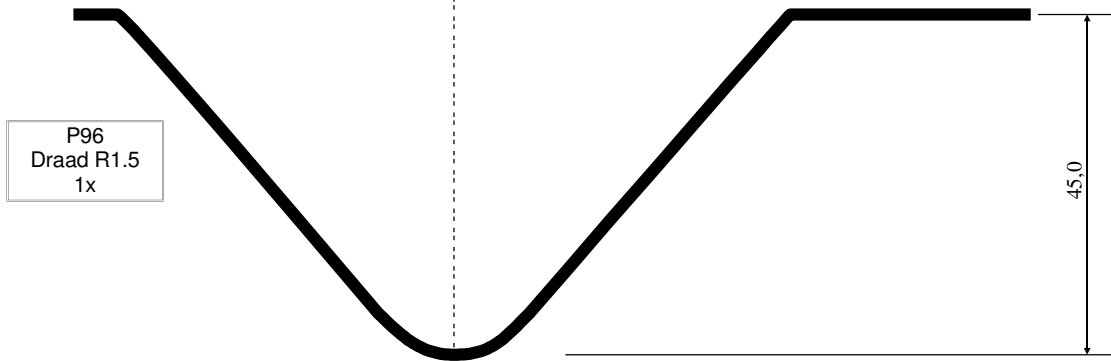

Materiaal:
 Meubelplaat dik 18mm
 Kleur: Wit

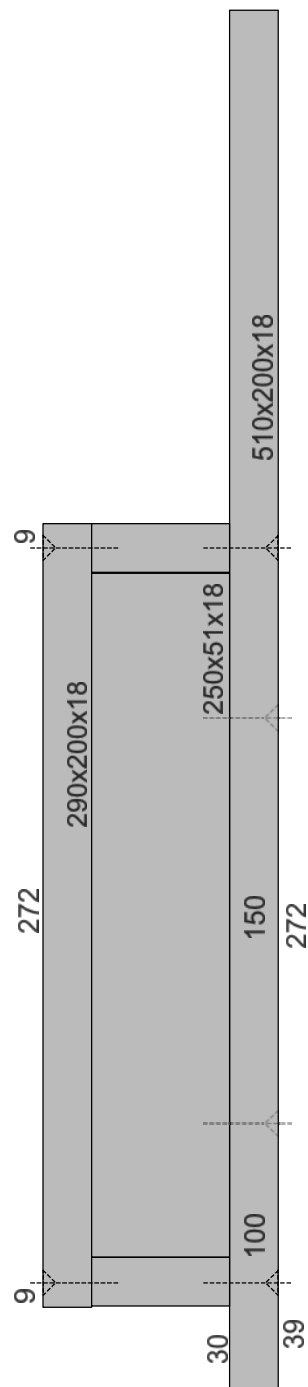
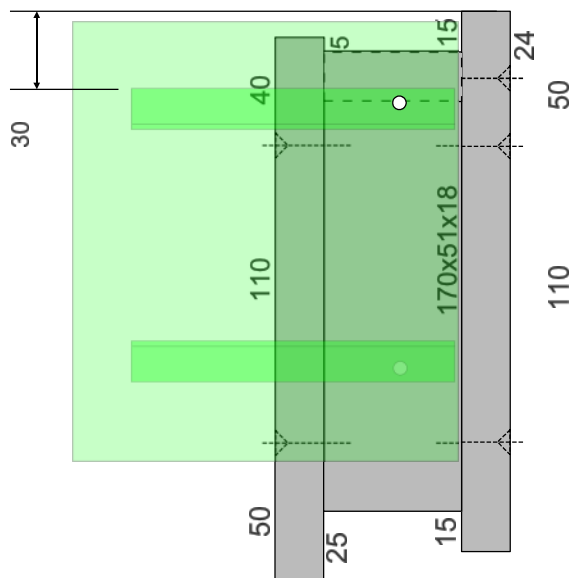
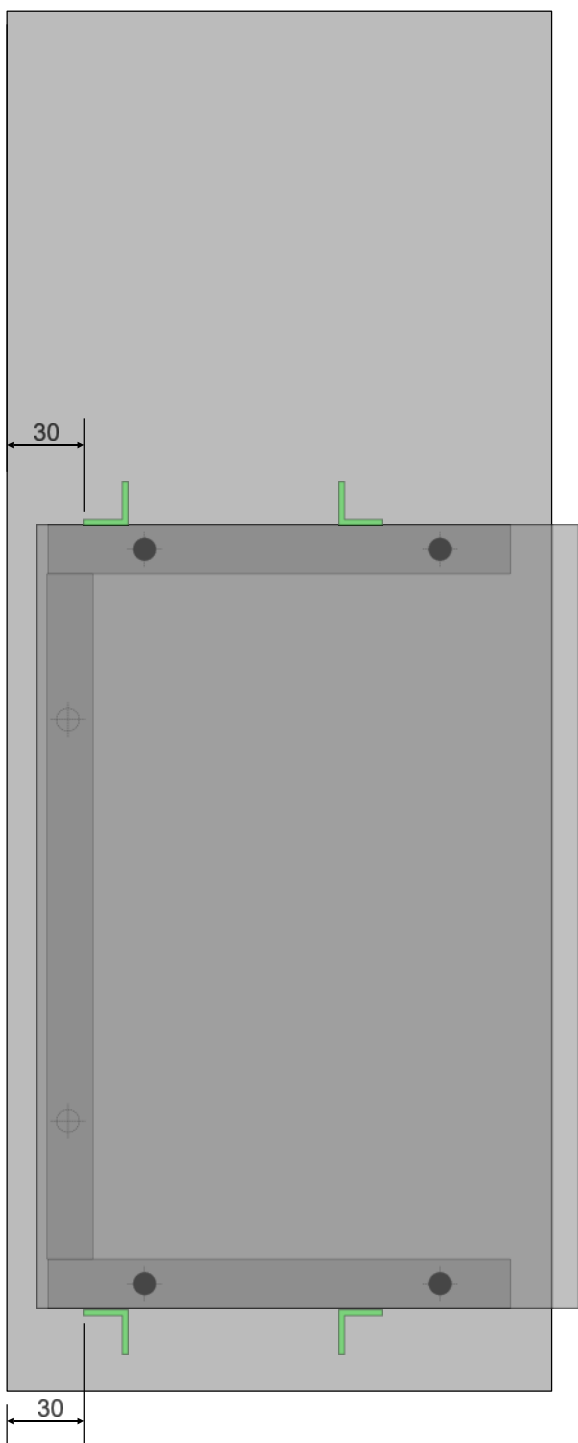

Copyright JanvdVen

Houtwerk

1-8-2009 Rev:
 Teknr: KVM-81

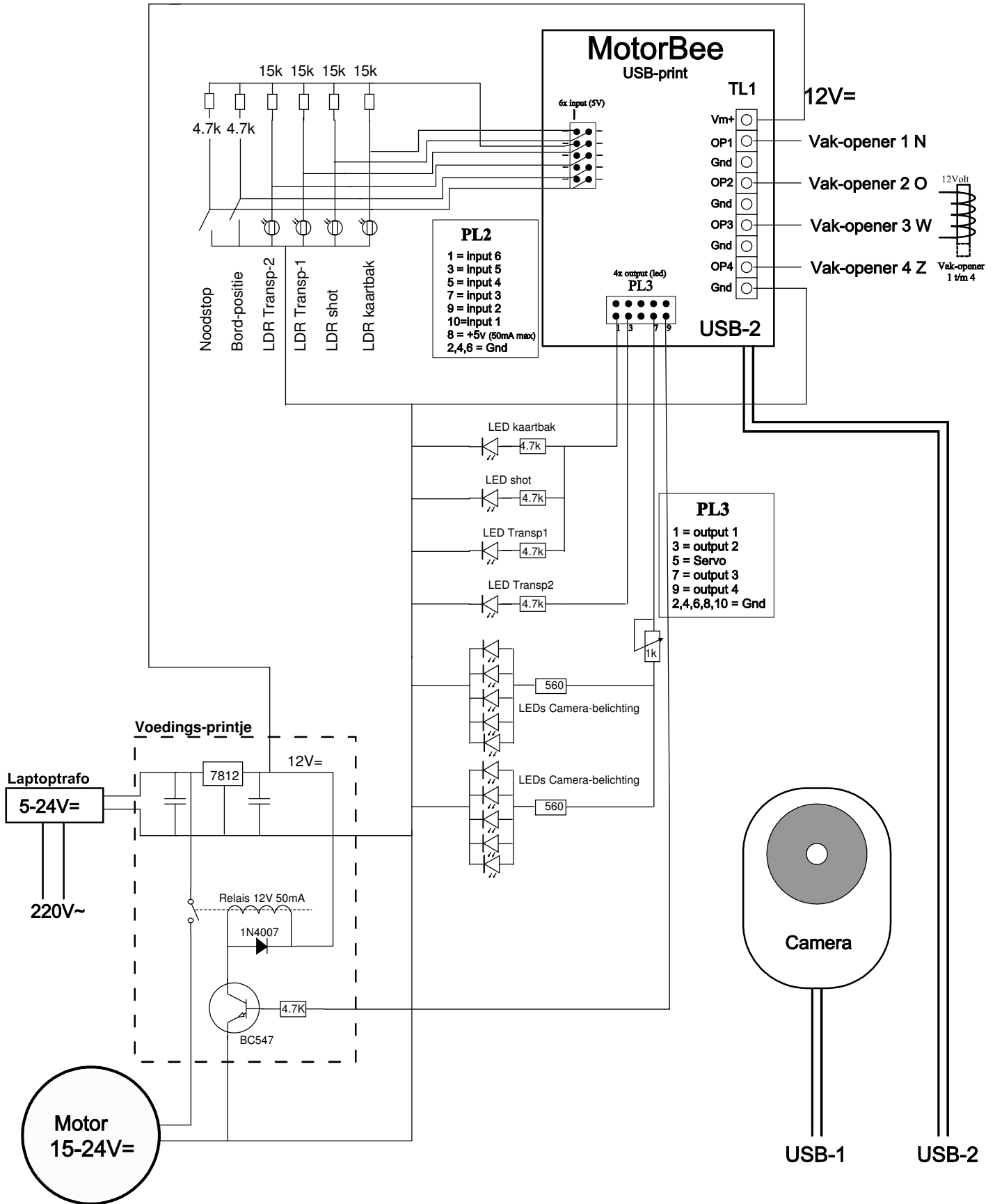

Werkspanning: Bandsnelheid: Tijd per spel:

16Volt	0.500 m/sec	13.4 sec
15 Volt	0.470 m/sec	14.0 sec
14 Volt	0.440 m/sec	14.6 sec

ca. waarden

Print getekend op 2x de ware grootte
 Print-afmeting: 65x76mm

In rood, groen en blauw:
 Op de print doorverboden bedrading

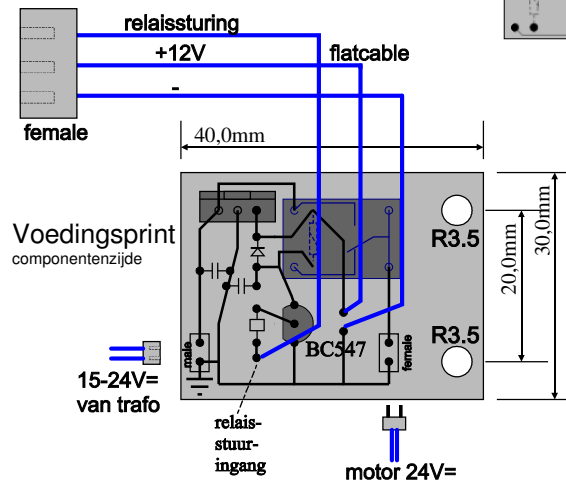
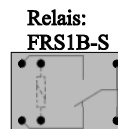
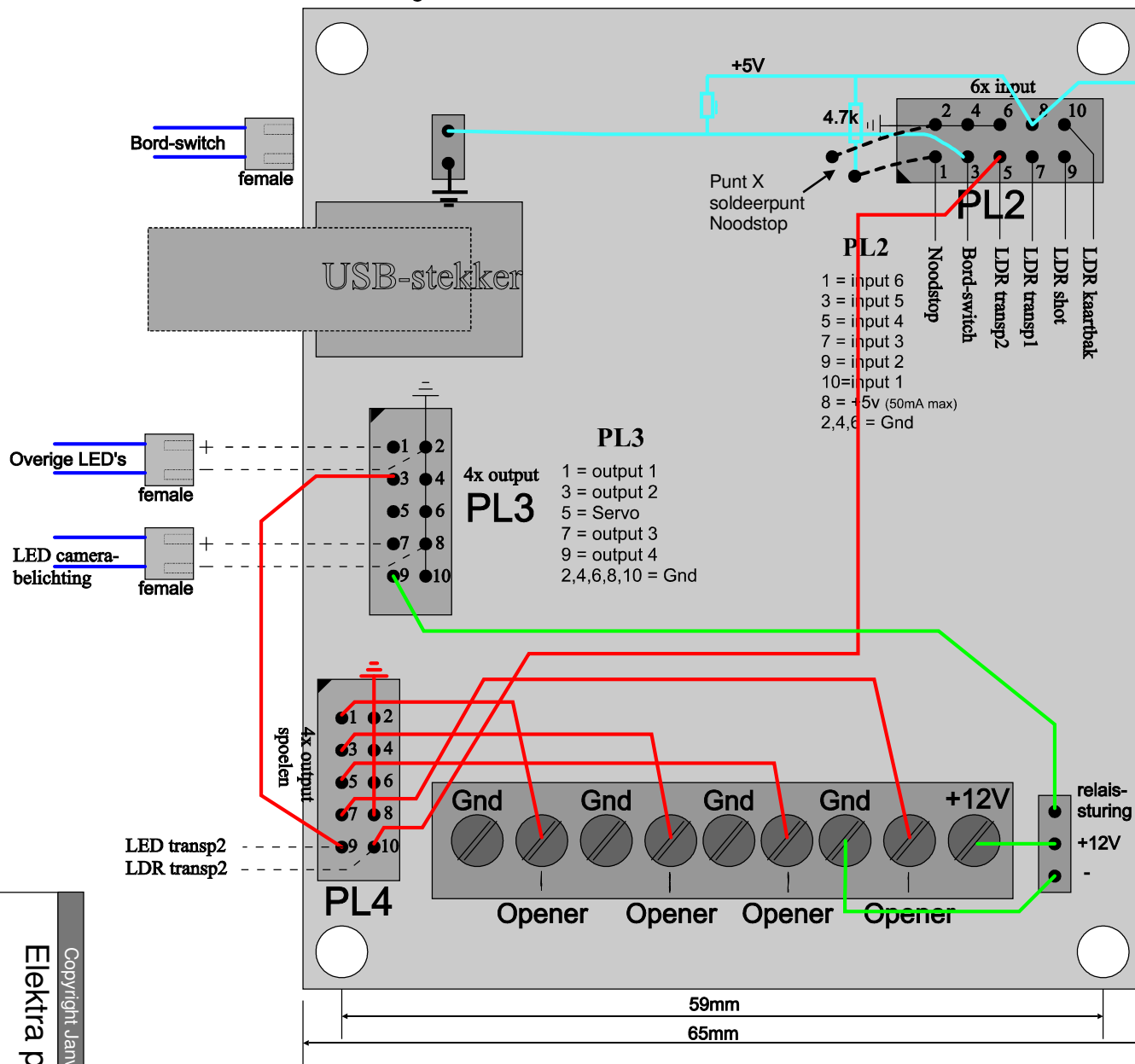

Print afmeting: 62x76mm
 Print getekend op 2x de ware grootte

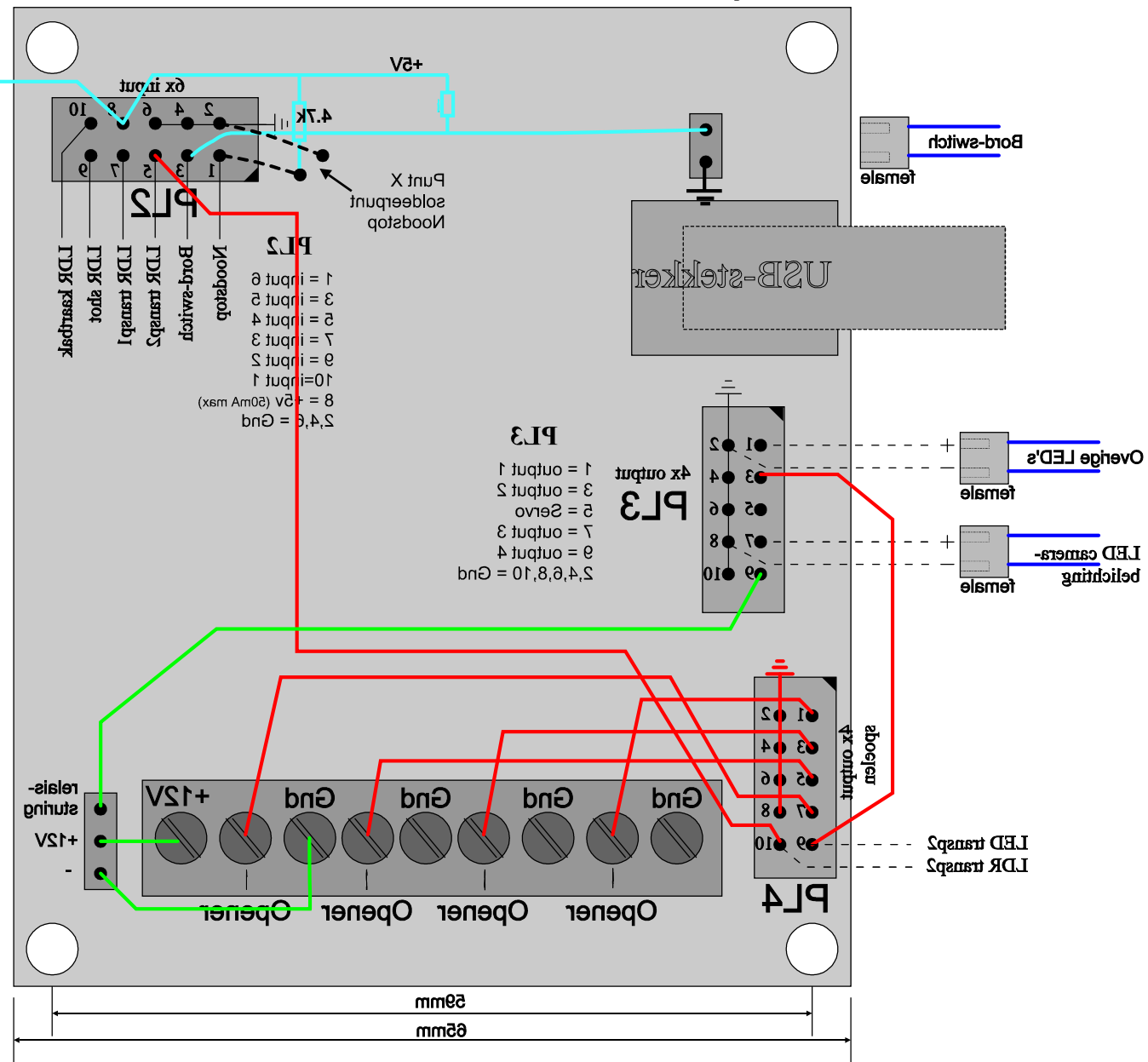

In rood, groen en blauw:
 Op de print doorverboden bedrading

Waarstanden nietgeprobeerd.
 Elk 15k op de print solderen.

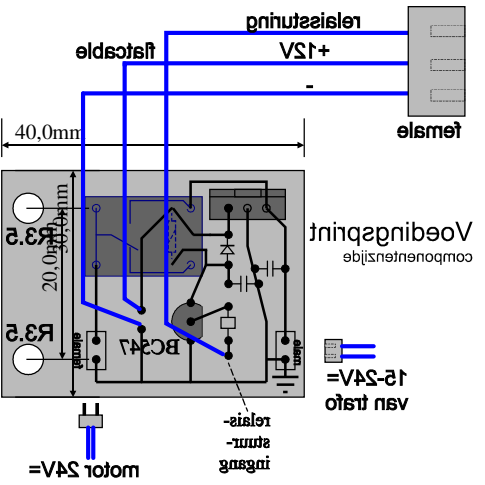
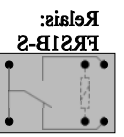

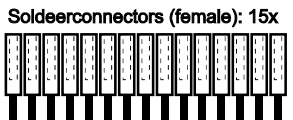
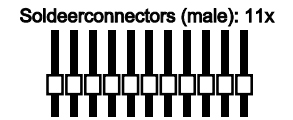
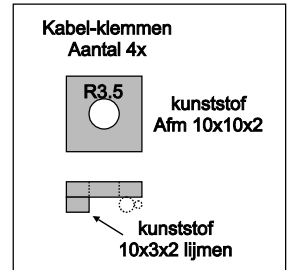
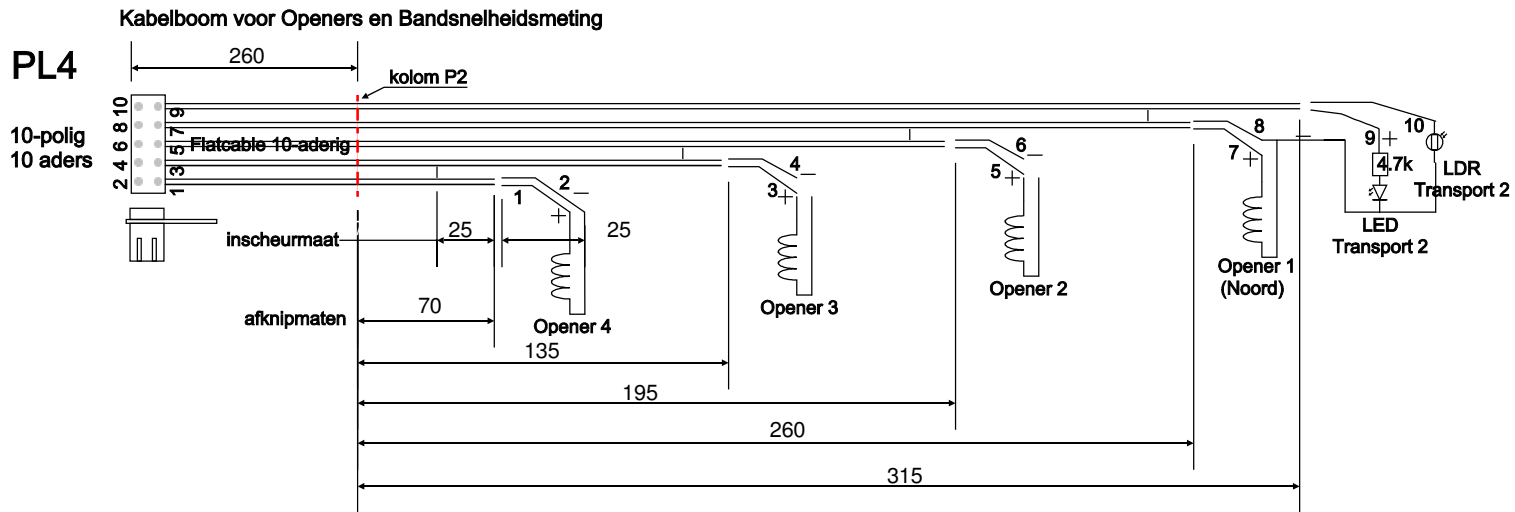
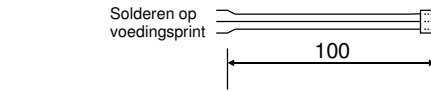
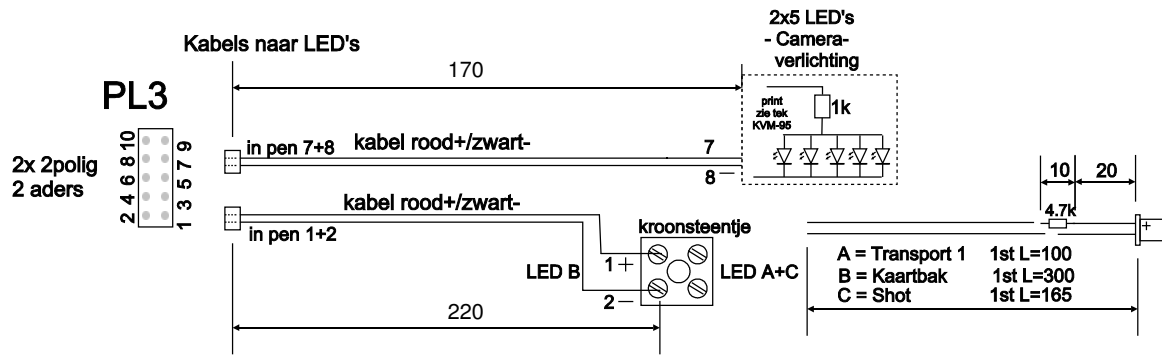
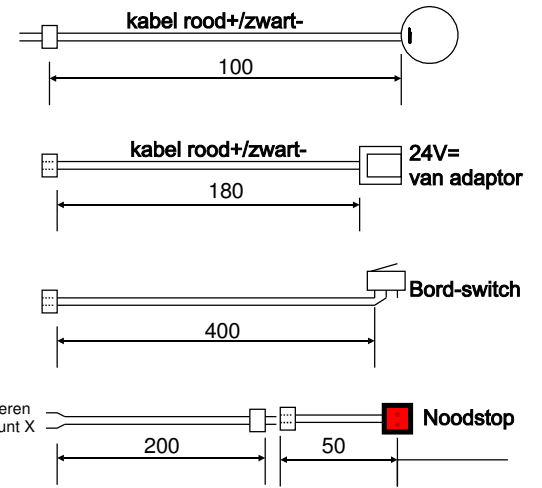
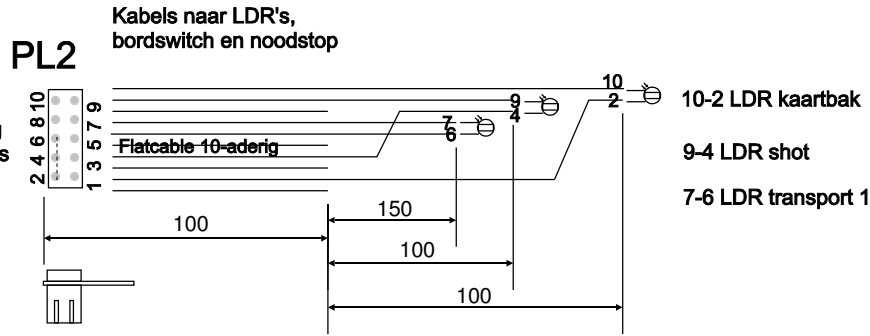

Soldeerzijde

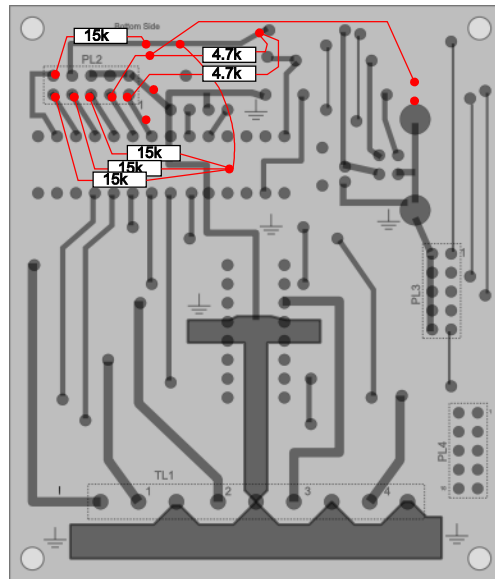

Onderdelenzijde

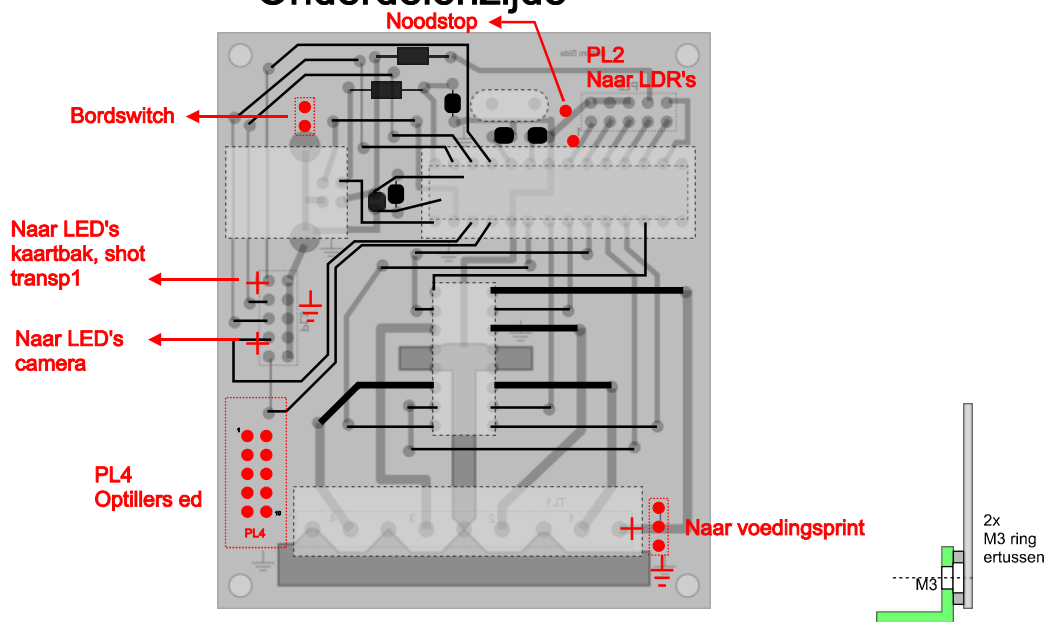

Printplaatje tbv Led-belichting camera
afmeting 76x10mm

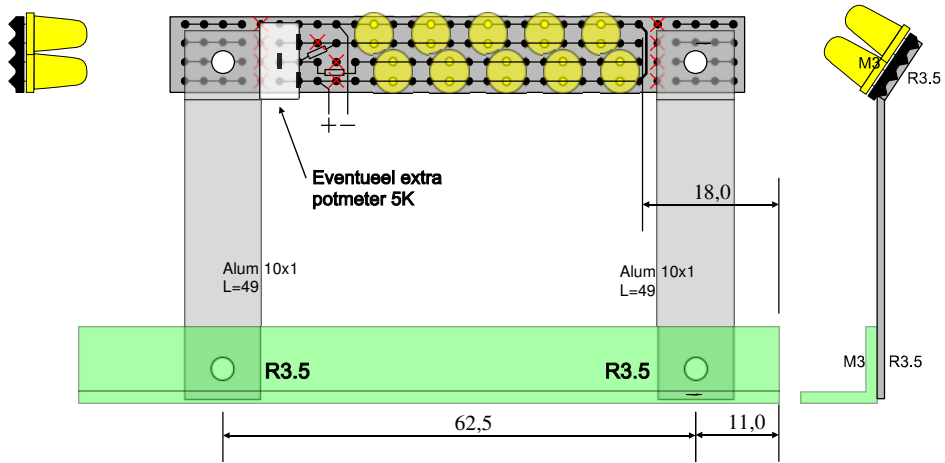

Copyright JanvdVen

Camera
belichting

1-8-2009 Rev:
Teknr: KVM-95